

BASIN INFORMATION

SUB-BASIN 1 (TO STREET)

ASPHALT AND DRIVEWAYS: 8,293 SF
SIDEWALK: 2,131 SF
LANDSCAPE: 3,790 SF

SUB-BASIN 2 (TO EXISTING)

EXISTING LANDSCAPE: 1,528 SF

SUB-BASIN 3 (TO EXISTING)

EXISTING LANDSCAPE: 4,789 SF
EXISTING FOREST / NATIVE: 3,676 SF

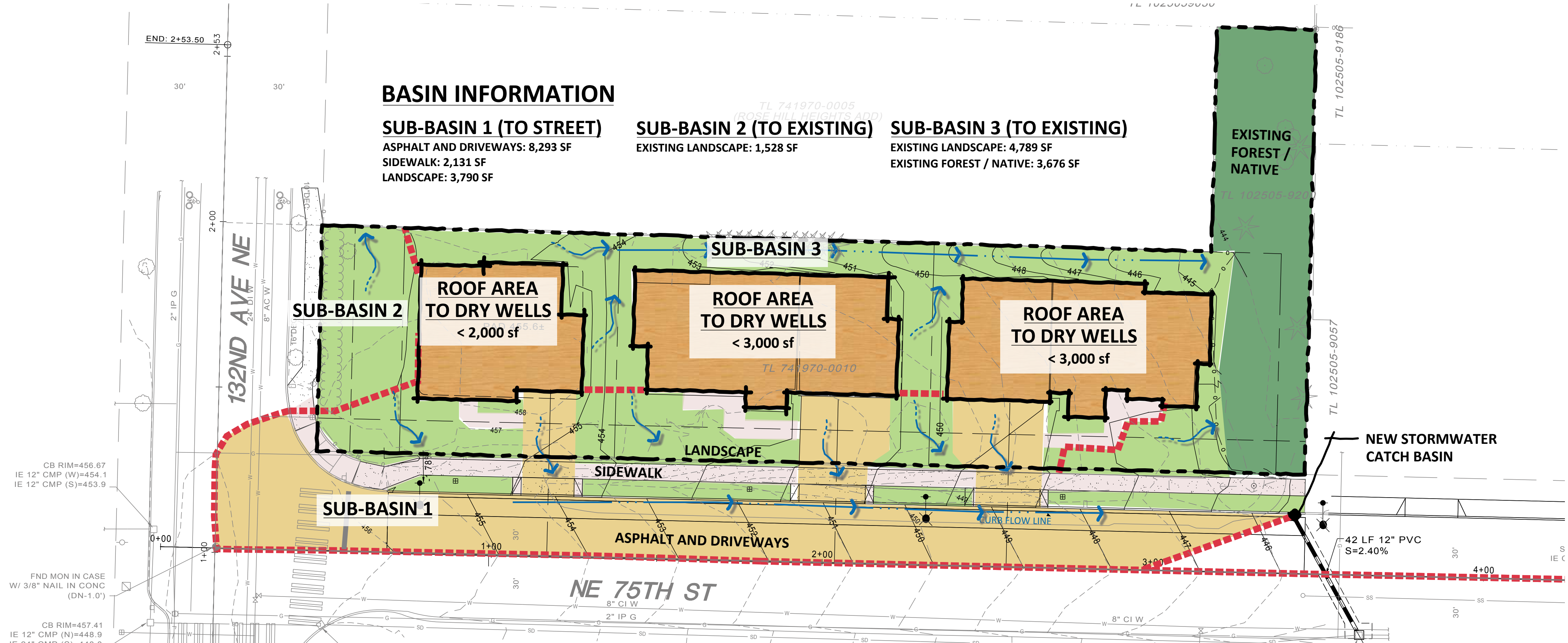

CB RIM=456.67
IE 12" CMP (W)=454.1
IE 12" CMP (S)=453.9

FND MON IN CASE
W/ 3/8" NAIL IN CONC
(DN-1.0')

CB RIM=457.41
IE 12" CMP (N)=448.9
IE 24" CMP (S)=448.9
IE 24"

RATIONAL METHOD									City of Redmond					
Nouri Short Plat														
Basin ID	Area SF	Area Acres	Forested C=0.15	Pervious C=0.25	Gravel C=0.80	Impervious C=0.90	C Ave	Tc Min	I 2yr in/hr	Q2 CFS	I 25yr in/hr	Q25 CFS	I 100 yr in/hr	Q100 CFS
Pre-Dev 1	13959.00	0.32	1258	3724	1890	7087	0.65	10	1.1	0.23	2.03	0.42	2.72	0.56
Pre-Dev 2	3229.00	0.07	0	2699	0	530	0.36	10	1.1	0.03	2.03	0.05	2.72	0.07
Pre-Dev 3	13991.00	0.32	2999	10077	0	915	0.27	10	1.1	0.10	2.03	0.18	2.72	0.24
Post Dev 1	14214.00	0.33	0	3790	0	10424	0.73	10	1.1	0.26	2.03	0.48	2.72	0.64
Post Dev 2	1528.00	0.04	0	1528	0	0	0.25	10	1.1	0.01	2.03	0.02	2.72	0.02
Post Dev 3	8465.00	0.19	3676	4789	0	0	0.21	10	1.1	0.04	2.03	0.08	2.72	0.11

EXHIBIT DESCRIPTION

STORMWATER RUNOFF QUANTITIES PROVIDED USING THE RATIONAL METHOD TO DEMONSTRATE THE INTENSITY OF FLOW AND DIRECTION OF THE STORMWATER DURING THE EXISTING PRE-DEVELOPED CONDITION AND THE PROPOSED DEVELOPED CONDITION. THE RATIONAL METHOD WAS USED AS A TOOL FOR COMPARISON ONLY. THE DRAINAGE REPORT REQUIRED FOR THIS PROJECT HAS BEEN PREPARED TO CONFORM TO THE CITY OF REDMOND REQUIREMENTS.

USING THE 2 YR STORM DURATION / INTENSITY NUMBERS THIS EXHIBIT SHOWS THAT THE SURFACE STORMWATER RUNOFF FLOWING OFF-SITE HAS BEEN REDUCED FROM 0.36 CFS (SUB-BASINS 1,2 AND 3) TO 0.05 CFS (SUB-BASINS 2 AND 3 ONLY).



EXHIBIT 1b

DEVELOPED SITE DRAINAGE MAP

10-9-2015

